

J D N | TECHNICAL DATA

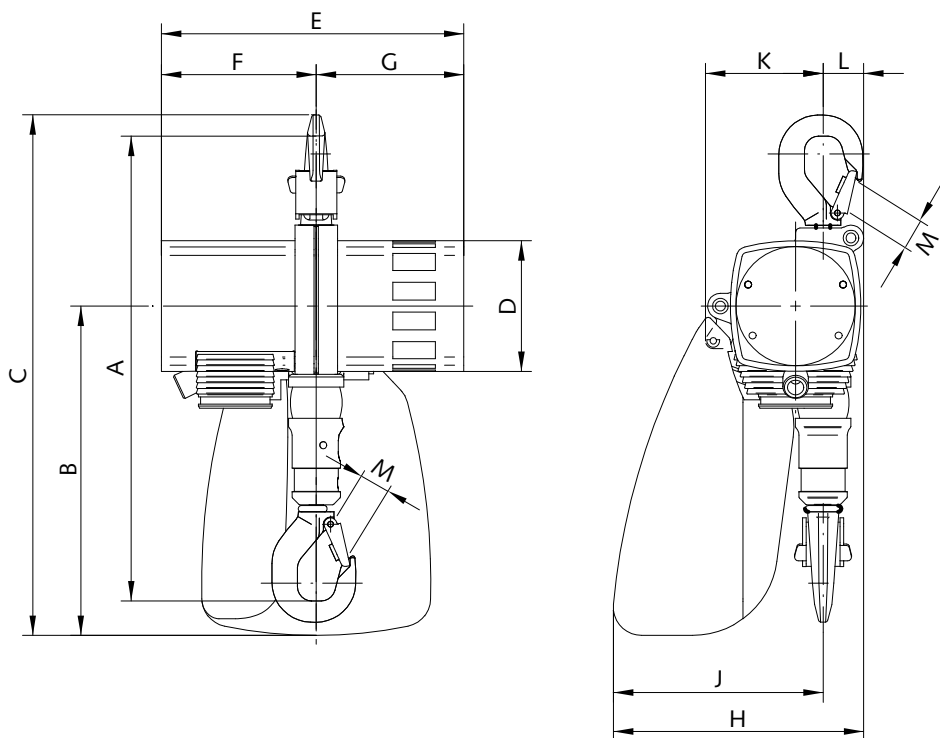

Type		mini 125	mini 250	mini 500	mini 1000
Carrying capacity	kg	125	250	500	1000*
Number of chain strands		1	1	1	1
Motor output	kW	0.4	0.4	1.0	1.0
Air pressure	bar	6	6	6	6
Lifting speed at full load	m / min	16	8	10	5
Lifting speed without load	m / min	40	20	24	12
Lowering speed at full load	m / min	32	16	20	10
Air consumption at full load	Lifting	0.5	0.5	1.2	1.2
	Lowering	0.7	0.7	1.6	1.6
Air connection		G $\frac{3}{8}$	G $\frac{3}{8}$	G $\frac{1}{2}$	G $\frac{1}{2}$
Hose dimension (\varnothing inside)	mm	9	9	13	13
Weight at standard lift (3 m) and 2 m length of control	kg	9.5	10.5	21	23
Chain dimension	mm	4x12	4x12	7x21	7x21
Weight of 1 m chain	kg	0.35	0.35	1.0	1.0
Heights of lift	m			3 / 5 / 8	
Lengths of control	m			2 / 4 / 6	
Driving mechanism group				1 Bm	
Dimensions in mm					
A		328	328	458	458
B		232	232	316	316
C		367	367	505	505
D		92	92	122	122
E		213	213	292	292
F		109	109	148	148
G		104	104	144	144
H		177	177	234	234
J		148	148	194	194
K		83	83	119	119
L		29	29	40	40
M		19	19	28	28

Power ratings at 2 m length of control

* Within the EU the highest capacity is 980 kg, thus no overload protection is necessary.

▶ JDN News

▶ The advantages at a glance